

DWR USE ONLY - DO NOT FILL IN

STATE WELL NO./STATION NO.

LATITUDE LONGITUDE

APN/TRS/OTHER

Page 1 of         
 Owner's Well No. Border Ave. Well #7 No. 585191  
 Date Work Began June 24, 1995, Ended Aug. 16, 1995  
 Local Permit Agency County of Los Angeles Environ. Health  
 Permit No.        Permit Date April 11, 1995

**GEOLOGIC LOG**

**WELL OWNER**

ORIENTATION (  $\angle$  )  VERTICAL  HORIZONTAL  ANGLE  (SPECIFY)

Name CITY OF TORRANCE

DEPTH TO FIRST WATER (Ft.) BELOW SURFACE

Mailing Address 3031 Torrance B lvd.

DEPTH FROM SURFACE

Ft. to Ft. DESCRIPTION Describe material, grain size, color, etc.

Torrance, Calif. 90509

CITY STATE ZIP

0	60	top soil
60	200	sand
200	210	clay and sand
210	230	sand
230	240	clay
240	250	sand
250	260	sand, rocks and clay
260	270	clay, sand
270	280	sand and clay
280	300	rock, sand and little clay
300	310	sand, clay and gravel
310	320	clay, sand
320	330	sand, clay, some gravel
330	340	sand and clay
340	350	sand
350	360	sand, clay and gravel
360	380	sand

WELL LOCATION

Address 2223 Border Ave.

City Torrance, Calif.

County Los Angeles

APN Book        Page        Parcel       

Township        Range        Section       

Latitude        NORTH Longitude        WEST

**LOCATION SKETCH**

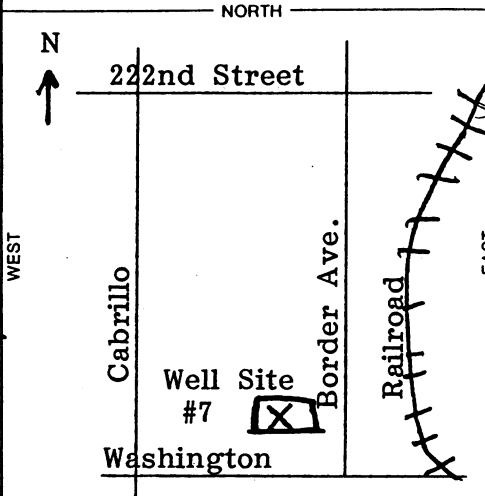

ACTIVITY (  $\angle$  ) -

NEW WELL

MODIFICATION/REPAIR

Deepen

Other (Specify)       

DESTROY (Describe Procedures and Materials Under "GEOLOGIC LOG")

PLANNED USE(S) (  $\angle$  )

MONITORING

WATER SUPPLY

Domestic

Public

Irrigation

Industrial

"TEST WELL"

CATHODIC PROTECTION

OTHER (Specify)       

continued on next page No. 585192

Depth from Surface Ft.	Bore Hole dia.	Material Type	Diam.	Wall Casing	Thickness
0	57	60"	Blank	139-B	36" .500"
+2	280	36"	"	304SS	26" .312
280	500	30"	Screen	"	20" CWW
500	560	"	Blank	"	20" .312
560	730	"	Screen	"	20" CWW
730	770	"	Blank	"	20" .312
770	850	"	Screen	"	20" CWW
850	870	"	Blank	"	20" .312

WEST EAST

Illustrate or Describe Distance of Well from Landmarks such as Roads, Buildings, Fences, Rivers, etc. PLEASE BE ACCURATE & COMPLETE.

DRILLING METHOD Reverse Circulation FLUID Water

WATER LEVEL & YIELD OF COMPLETED WELL

DEPTH OF STATIC WATER LEVEL 91 (Ft.) & DATE MEASURED 8/9/95

ESTIMATED YIELD 3400 (GPM) & TEST TYPE Pump

TEST LENGTH 72 (Hrs.) TOTAL DRAWDOWN 39 (Ft.)

\* May not be representative of a well's long-term yield.

(0' to 57 ft. cement -(0' to 250 ft. Cement and (250' to 870 ft. 8x16)

TOTAL DEPTH OF BORING 950 (Feet)

TOTAL DEPTH OF COMPLETED WELL 870 (Feet)

DEPTH FROM SURFACE	BORE-HOLE DIA. (Inches)	CASING(S)							
		TYPE ( $\angle$ )				MATERIAL / GRADE	INTERNAL DIAMETER (Inches)	GAUGE OR WALL THICKNESS	SLOT SIZE IF ANY (Inches)
Ft. to Ft.	BLANK	SCREEN	CON-DOCTOR	FILL PIPE					
NOTE: SEE ABOVE FOR THIS SECTION									

DEPTH FROM SURFACE	ANNULAR MATERIAL			
	TYPE			
Ft. to Ft.	CE-MENT ( $\angle$ )	BEN-TONITE ( $\angle$ )	FILL ( $\angle$ )	FILTER PACK (TYPE/SIZE)
NOTE: SEE ABOVE FOR THIS Section.....				

**ATTACHMENTS (  $\angle$  )**

**CERTIFICATION STATEMENT**

- Geologic Log
  - Well Construction Diagram
  - Geophysical Log(s)
  - Soil/Water Chemical Analyses
  - Other
- ATTACH ADDITIONAL INFORMATION, IF IT EXISTS.

I, the undersigned, certify that this report is complete and accurate to the best of my knowledge and belief.

NAME BEYLIK DRILLING, INC.

(PERSON, FIRM, OR CORPORATION) (TYPED OR PRINTED)

ADDRESS 555 South Harbor Blvd. La Habra, Calif. 90631

CITY STATE ZIP

Signed T. Caldwell DATE SIGNED Aug. 23, 1995 306291

WELL DRILLER/AUTHORIZED REPRESENTATIVE DATE SIGNED C-57 LICENSE NUMBER

STATE OF CALIFORNIA  
**WELL COMPLETION REPORT**  
Refer to Instruction Pamphlet

DWR USE ONLY - DO NOT FILL IN

STATE WELL NO./STATION NO.

LATITUDE LONGITUDE

APN/TRS/OTHER

Page 2 of \_\_\_\_\_  
 Owner's Well No. Border Ave. Well #7 No. 585192  
 Date Work Began June 24, 1995 Ended Aug. 23, 1995  
 Local Permit Agency COUNTY Los Angeles Environ. Health  
 Permit No. \_\_\_\_\_ Permit Date April 11, 1995

DEPTH FROM SURFACE		DESCRIPTION <i>Describe material, grain size, color, etc.</i>
Ft.	to Ft.	
380	390	sand and clay
390	400	sand and gravel
400	410	sand, gravel and clay
410	420	sand, clay
420	430	sand
430	440	fine sand
440	470	sand and clay
470	480	sand
480	490	clay, sand
490	500	clay, gravel
500	520	clay, sand
520	530	sand
530	550	clay
550	560	sand, clay
560	590	sand
590	680	fine sand
680	690	sand
690	700	clay, some sand
700	710	fine sand
710	740	clay, fine sand
740	750	clay
750	760	fine sand, clay
760	910	fine sand
910	920	fine sand, gravel
920	930	fine sand, gravel and rock
930	940	fine sand, gravel
940	950	fine sand
		end end
TOTAL DEPTH OF BORING <u>950</u> (Feet)		
TOTAL DEPTH OF COMPLETED WELL <u>870</u> (Feet)		

**WELL OWNER**

Name CITY OF TORRANCE  
 Mailing Address 3031 Torrance Blvd.  
Torrance, Calif. 90509  
 CITY \_\_\_\_\_ STATE \_\_\_\_\_ ZIP \_\_\_\_\_

**WELL LOCATION**

Address 2223 Border Ave.  
 City Torrance, Calif.  
 County Los Angeles  
 APN Book \_\_\_\_\_ Page \_\_\_\_\_ Parcel \_\_\_\_\_  
 Township \_\_\_\_\_ Range \_\_\_\_\_ Section \_\_\_\_\_  
 Latitude \_\_\_\_\_ NORTH Longitude \_\_\_\_\_ WEST

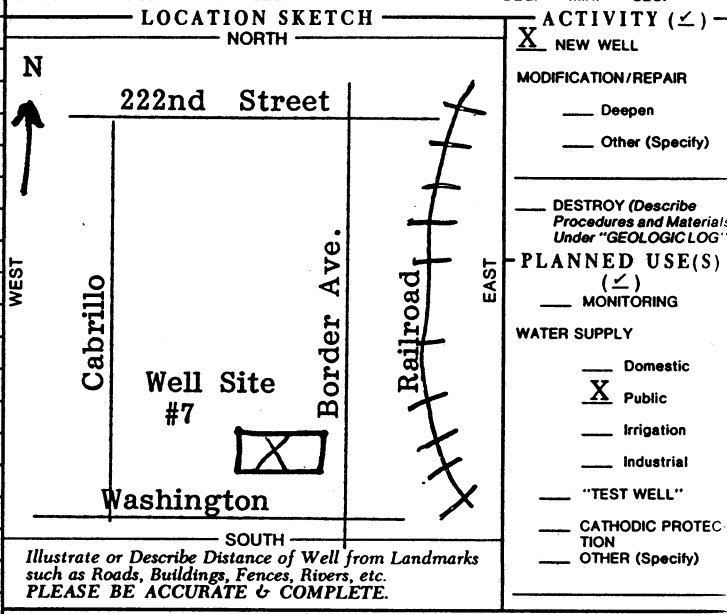

**DRILLING METHOD** Reverse Circulation FLUID Water

**WATER LEVEL & YIELD OF COMPLETED WELL**

DEPTH OF STATIC WATER LEVEL 91 (Ft.) & DATE MEASURED 8/9/95

ESTIMATED YIELD 3400 (GPM) & TEST TYPE Pump

TEST LENGTH 72 (Hrs.) TOTAL DRAWDOWN 39 (Ft.)

\* May not be representative of a well's long-term yield.

DEPTH FROM SURFACE Ft. to Ft.	BORE-HOLE DIA. (Inches)	CASING(S)						
		TYPE ( )				MATERIAL / GRADE	INTERNAL DIAMETER (Inches)	GAUGE OR WALL THICKNESS
BLANK	SCREEN	CONDUCTOR	FILL PIPE					
<b>NOTE: (See Page No. 1 (#585191 for this section))</b>								

DEPTH FROM SURFACE Ft. to Ft.	ANNULAR MATERIAL TYPE			
	CE- MENT ( )	BEN- TONITE ( )	FILL ( )	FILTER PACK (TYPE/SIZE)
0 : 57	X			
0 : 250	X			
250 : 870				8 x 16

- ATTACHMENTS ( )**
- \_\_\_ Geologic Log
  - \_\_\_ Well Construction Diagram
  - \_\_\_ Geophysical Log(s)
  - \_\_\_ Soil/Water Chemical Analyses
  - \_\_\_ Other \_\_\_\_\_
- ATTACH ADDITIONAL INFORMATION, IF IT EXISTS.

**CERTIFICATION STATEMENT**

I, the undersigned, certify that this report is complete and accurate to the best of my knowledge and belief.

NAME BEYLIK DRILLING, INC.  
 (PERSON, FIRM, OR CORPORATION) (TYPED OR PRINTED)

ADDRESS 555 South Harbor Blvd. La Habra, Calif. 90631  
 CITY STATE ZIP

Signed T. Chaboull Aug. 23, 1995 306291  
 WELL DRILLER/AUTHORIZED REPRESENTATIVE DATE SIGNED C-57 LICENSE NUMBER

AS-BUILT SKETCH

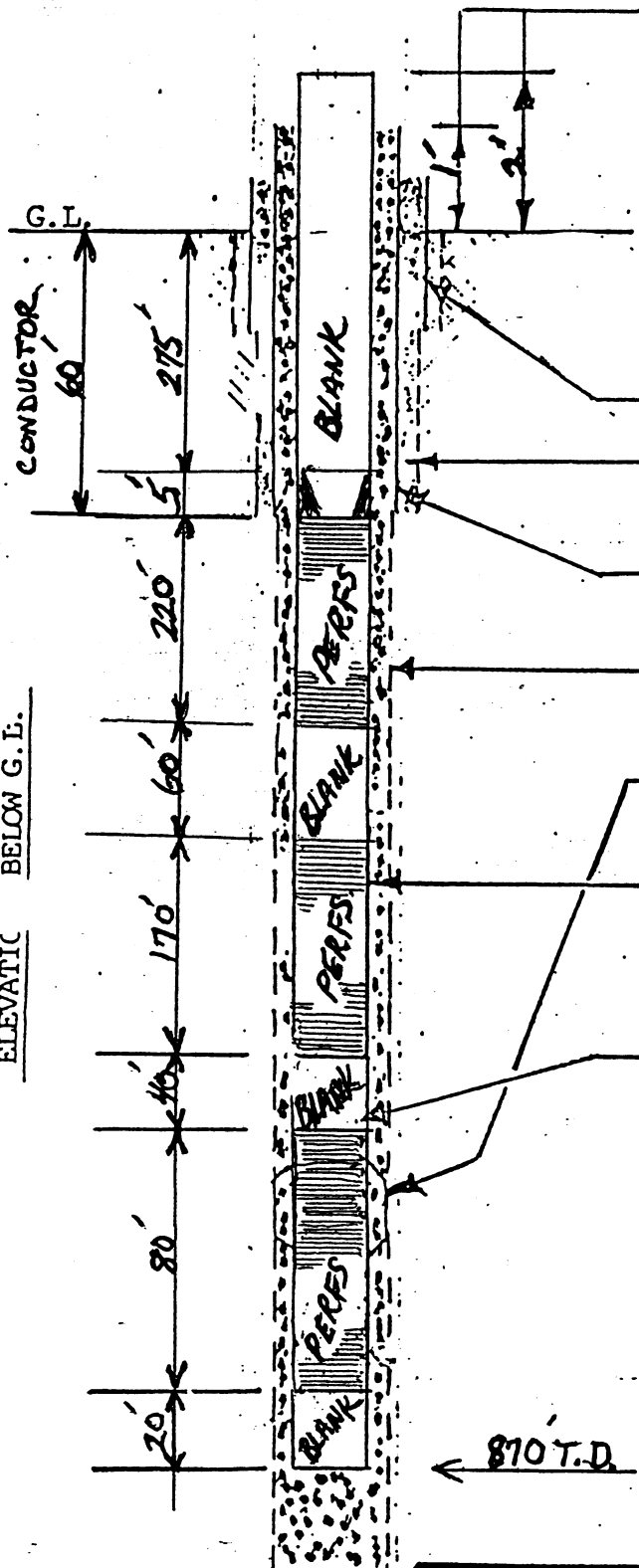

Stick-ups per Owner's Requirements

Gravel Chute if Required: (Not Shown)

3" X 255" GRAVEL FEED LINE

Sounding Tube if Required: (Not Shown)

2" X 245"

Sanitary Seal from: 0 Ft. to: 250 Ft.

Surface Pipe (Contractor's Option)

Grout: 10% SAND SLURRY

Conductor Pipe: 42" O.D. x 1/2" Wall

Drilled Hole: 36" X 30" Dia.

Centralizers @ 80' Intervals in Perforated Zone Only ✓

Casing: 20" & 26" O.D. or \_\_\_\_\_ I.D. x 5/16" Wall

Material: STAINLESS

Perforations:

Type: ROSCOE MOSS SS. WIRE WRAP

Width: \_\_\_\_\_

Open Area per Foot: \_\_\_\_\_

Gravel: From: 250 ft. to 900 Ft.

← 870' T.D.

JOB NO. 2283

**BEYLIK DRILLING, INC.**

555 South Harbor Blvd. LA HABRA, CALIFORNIA 90631  
(310) 691-0903 (714) 870-5360 FAX (310) 690-9192

WATER WELL DRILLING • MONITORING WELLS • WELL AND PUMP REPAIR • TEST HOLES  
STATE OF CALIFORNIA CONTRACTOR'S NO. 306291-C-57 & SC-61

TITLE: CITY OF TORRANCE WELL #7 - BORDER AVE. WELL #7

DR. BY: Tony Romero DATE: 7/18/95 No: \_\_\_\_\_ REV. \_\_\_\_\_

## BEYLIK DRILLING

DEVIATION SURVEY LOGCustomer: CITY OF TORRANCE Well Name/#: BORDER AVE. WELL No. 7Survey Performed By: Tony Casolari Date: August 18, 1995

Depth	North	South	East	West
20	0		--	
30	--		--	
40	--		1/16	
50	--		1/16	
60	--		1/16	
70	1/16		1/16	
80	1/16		1/16	
90	1/16		1/16	
100	1/16		1/16	
110	1/16		1/16	
120	1/16		1/8	
130	1/16		1/8	
140	1/16		1/8	
150	1/16		1/8	
160	1/16		1/8	
170	1/16		1/2	
180	1/16		1/8	
190	1/16		1/8	

Job# 2283

**BEYLIK DRILLING INC.**  
 555 S. HARBOR BLVD.  
 LA HABRA, CALIF. 90631  
 (310) 691-0903 • (714) 870-5360

BEYLIK DRILLING

DEVIATION SURVEY LOG

Customer: CITY OF TORRANCE Well Name/#: BORDER AVE. WELL No. 7

Survey Performed By: Tony Casolari Date: August 18, 1995

Depth	North	South	East	West
200	1/2		1/2	
210	1/8		1/8	
220	1/2		1/8	
230	1/8		1/2	
240	1/8		1/8	
250	1/8		1/2	
260	3/16		1/2	
270	3/16		1/2	
280	3/16		1/2	
290	1/4		1/8	
300	1/4		1/2	
310	1/4		1/2	
320	1/4		1/2	
330	1/4		1/2	
340	1/4		1/16	
350	3/16		1/16	
360	3/16		1/16	
370	3/16		1/16	

Job# 2283

BEYLIK DRILLING

DEVIATION SURVEY LOG

Customer: CITY OF TORRANCE Well Name/#: BORDER AVE. WELL No. 7

Survey Performed By: Tony Casolari Date: August 18, 1995

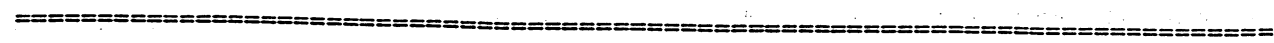

Depth	North	South	East	West
380	3/16		1/16	
390	3/16		1/16	
400	3/16		1/16	
410	3/16		1/8	
420	3/16		1/8	
430	3/16		1/8	
440	3/16		1/8	
450	3/16		1/2	
460	3/16		1/8	
470	3/16		1/8	
480	1/2		1/8	
490	1/8		1/2	
500	1/8		1/8	
510	1/8		1/2	
520	1/8		1/2	
530	1/8		1/2	
540	1/8		1/8	
550	1/8		1/8	

Job# 2283

## BEYLIK DRILLING

DEVIATION SURVEY LOGCustomer: CITY OF TORRANCE Well Name/#: BORDER AVE. WELL No. 7Survey Performed By: Tony Casolari Date: August 18, 1995

Depth	North	South	East	West
560	1/8		1/2	
570	1/8		1/2	
580	1/2		1/2	
590	3/16		1/16	
600	3/16		1/16	
610	3/16		1/16	
620	3/16		1/16	
630	3/16		1/16	
640	3/16		1/16	
650	3/16		1/16	
660	3/16		1/16	
670	3/16		1/16	
680	3/16		1/16	
690	3/16		1/16	
700	3/16		1/16	
710	3/16		1/16	
720	1/4		1/16	
730	1/4		1/16	

Job # 2283

BEYLIK DRILLING

DEVIATION SURVEY LOG

Customer: CITY OF TORRANCE Well Name/#: BORDER AVE. WELL No. 7

Survey Performed By: Tony Casolari Date: Aug. 23, 1995

=====

Depth	North	South	East	West
740	3/16		1/16	
750	3/16		1/16	
760	3/16		1/16	
780	3/16		1/16	
790	3/16		1/16	
800	3/16		1/16	
810	3/16		1/16	
820	3/16		1/16	
830	3/16		1/16	
840	3/16		1/16	
850	3/16		1/16	
860	3/16		1/16	

Job # 2283