

TT/T1007

LAYOUT BELOW APPLIES WHEN AN EXISTING RAISED MEDIAN SEPARATES OPPOSING DIRECTIONS OF TRAFFIC

LAYOUT BELOW APPLIES WHEN THERE IS NO RAISED MEDIAN TO SEPARATE OPPOSING TRAFFIC

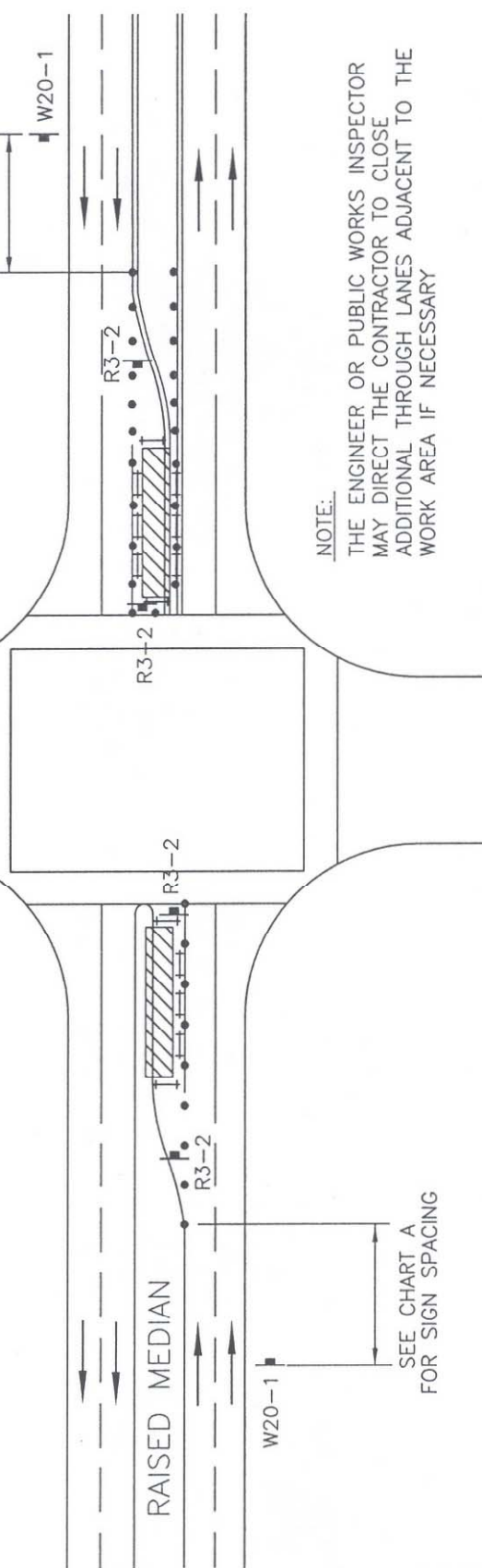

NOTE:
THE ENGINEER OR PUBLIC WORKS INSPECTOR MAY DIRECT THE CONTRACTOR TO CLOSE ADDITIONAL THROUGH LANES ADJACENT TO THE WORK AREA IF NECESSARY

CONSTRUCTION SIGNS:



LEGEND:



CHART A

DESIGN SPEED	MINIMUM RECOMMENDED DELINEATOR AND SIGN PLACEMENT		SIGN SPACING (ADVANCE OF TAPER AND BETWEEN SIGNS)
	TAPER LENGTH (EACH LANE)	DELINEATOR SPACING (TAPER) (TANGENT)	
35 MPH	250 FT.	25 FT.	250 FT.
40 MPH	350 FT.	25 FT.	350 FT.
45 MPH	550 FT.	25 FT.	550 FT.
50 MPH	600 FT.	25 FT.	600 FT.

CITY OF TORRANCE - WORK AREA TRAFFIC CONTROL

DATE ISSUED
27 FEB 2008

**ARTERIAL & COLLECTOR
LEFT TURN LANE CLOSURE**

ROBERT J. BESTE
PUBLIC WORKS DIRECTOR
R.C.E. NO. 50737

STANDARD NO.
T1007

SHEET 1 OF 1