

TT/T1004

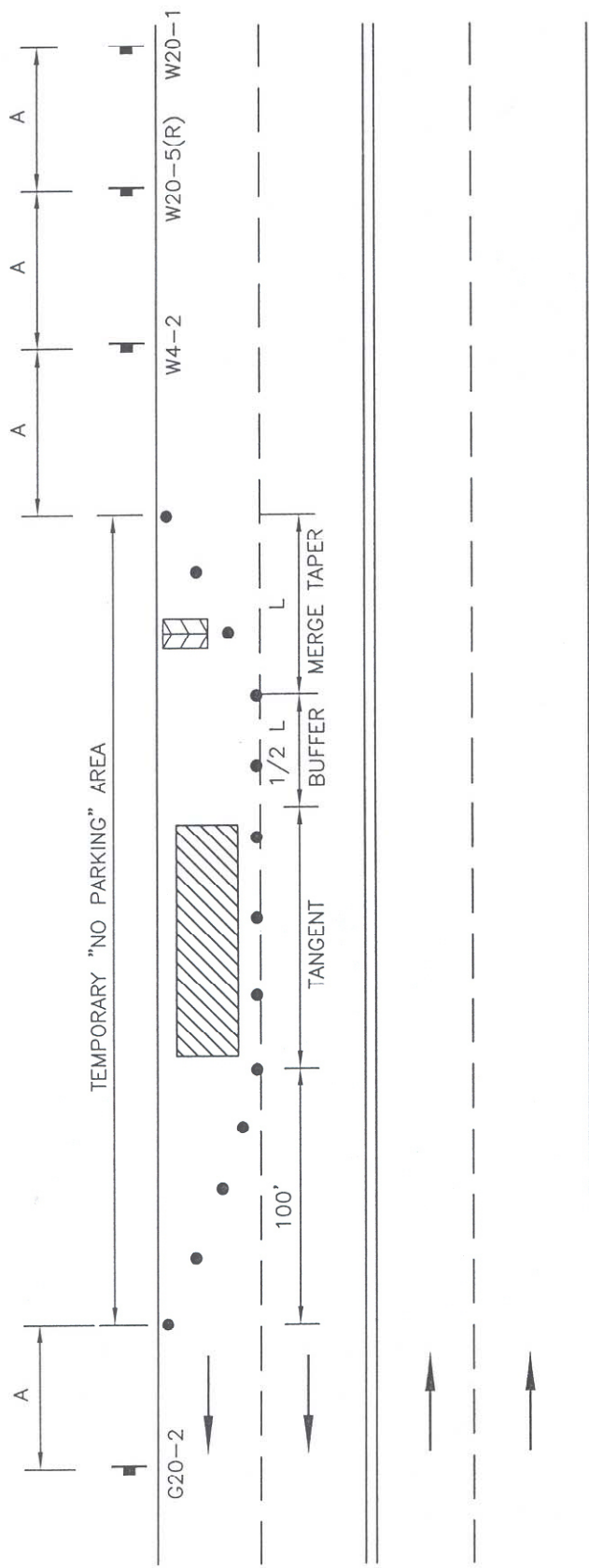

CONSTRUCTION SIGNS:

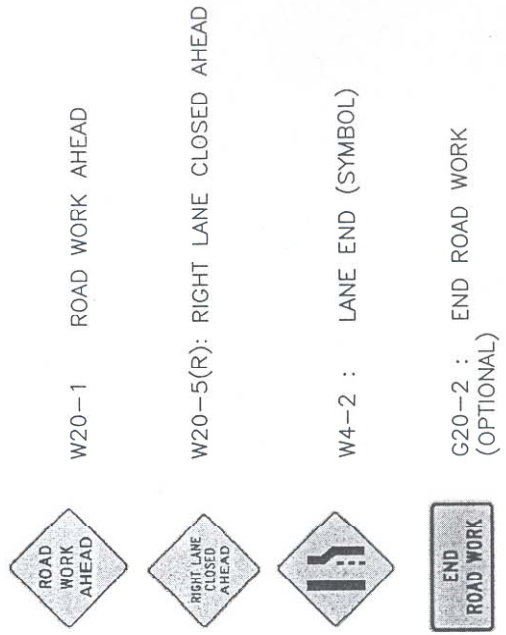

DESIGN SPEED	MINIMUM RECOMMENDED DELINEATOR AND SIGN PLACEMENT		BUFFER LENGTH (1/2 L)		
	MERGE TAPER LENGTH (L)	DELINEATOR SPACING (TANGENT)		DISTANCE BETWEEN SIGNS (A)	
30 MPH	180 FT.	30 FT.	60 FT.	100 FT.	90 FT.
35 MPH	245 FT.	35 FT.	70 FT.	100 FT.	125 FT.
40 MPH	320 FT.	40 FT.	80 FT.	100 FT.	160 FT.
45 MPH	540 FT.	45 FT.	90 FT.	350 FT.	270 FT.
50 MPH	600 FT.	50 FT.	100 FT.	350 FT.	300 FT.

- LEGEND:
- TRAFFIC DRUM OR 36" POST TUBE DELINEATOR
 - SIGN WITH FLAG TREE
 - ▨ WORK AREA
 - FLASHING LEFT ARROW
 - TRAFFIC DIRECTION

CITY OF TORRANCE - WORK AREA TRAFFIC CONTROL

DATE ISSUED
19 FEB 2008

**ARTERIAL & COLLECTOR
RIGHT LANE CLOSURE**

ROBERT J. BESTE
PUBLIC WORKS DIRECTOR
R.C.E. NO. 50737

STANDARD NO.
T1004
SHEET 1 OF 1